

Premium flooring solutions

# SPECTRUM NUWAY

Value Engineered  
Flooring Systems

## Designed For Premium Performance.

Versatile and hard wearing, Spectrum Nuway is suitable for all types of locations, whether high or low volume traffic. A genuine double sided solution with indoor and outdoor options, Spectrum Nuway provides an attractive, durable, and proven by time solution to the problem of soiling.





^ Design

**DESIGNED TO REMOVE  
DIRT AND MOISTURE AT  
THE POINT OF ENTRY.**

# The Mark of True Performance.

Spectrum Nuway, the name synonymous with high quality entrance flooring systems. Where ever you see the Spectrum Nuway symbol you can be assured of true performance. Spectrum has been at the forefront of specialist entrance flooring technology for over 35 years and is committed to long term development, providing innovative, state of the art products to meet market and customer needs. Each product within the range has a unique design, specifically engineered to reduce soiling at the point of entry.

Research shows that 90% of dirt and moisture entering a building is carried in by foot and wheeled traffic. Floor maintenance costs are proportional to the relationship between volume and type of traffic, the external environments and the size and position of an installed entrance flooring system.

35 years of experience confirms that Spectrum Nuway Design is effective in controlling floor maintenance costs and reducing slip hazards.

## DESIGN OPTIONS

Handcrafted graphics and logos available

## DURABLE AND SAFE

Robust construction

Resistant to fungal and bacterial growth

Optimum surface friction

Fire safety tested

Non reflective aluminium extrusions

## CUSTOM SOLUTIONS

Craftsman controlled manufacture shaped to individual requirements

## LOW LIFE CYCLE COSTS

Optimum dirt and moisture retention

Extends the life of secondary floor surfaces

Reduced cleaning and maintenance costs

Reversibility means longevity

Modular format

## TECHNICAL SUPPORT AND AFTERCARE

Support available for designing, specifying, installation, cleaning and maintenance.

Call 1300 786 585 for technical advice.

# Component Configurations

Versatile and hard wearing, Spectrum's Spectrum Nuway is suitable for all types of locations, whether high or low volume traffic.

With indoor and outdoor options, Spectrum Nuway provides an attractive, durable, and proven by time solution to the problem of soiling.

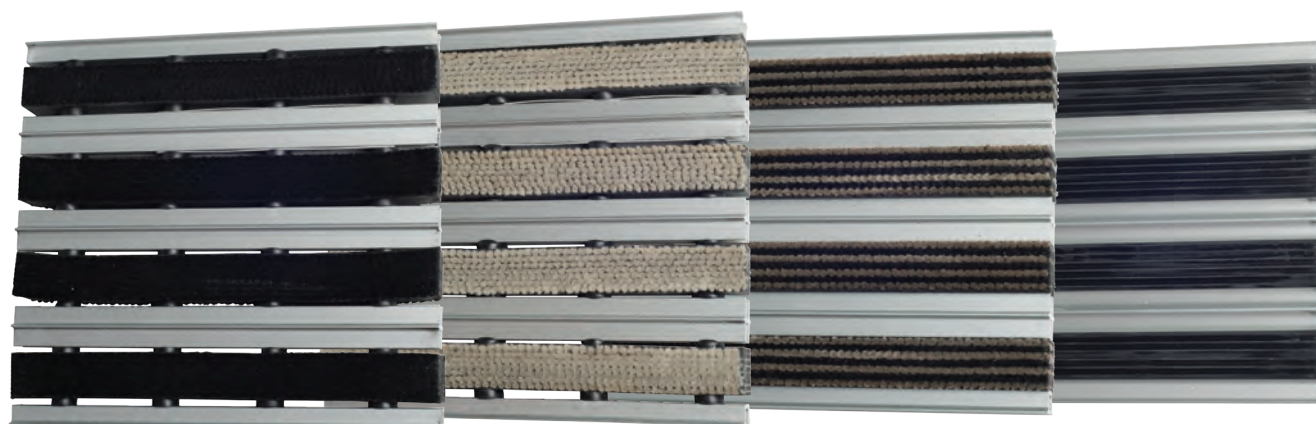

Design semi open

Classic semi open

DUO Closed

Duraguard Closed

DESIGN	CLASSIC	DUO	DURAGUARD
Buffed and dyed rubber wiper strips with aluminium scraper bars. Module 1 & 2 semi-open & Closed	Buffed natural grey wiper strips with aluminium scraper bars. Module 1 & 2 semi-open & closed	Buffed wiper strips in standard colour range with aluminium scraper bars. Module 1 & 2 semi-open & closed	Rubber (EPDM) strips with natural anodised aluminium scraper bars. Module 1 & 2 semi-open and closed
12mm& 17mm INTERNAL USE only	12mm& 17mm INTERNAL USE only	12mm& 17mm INTERNAL USE only	12mm& 17mm EXTERNAL and INTERNAL USE



^ Design

# CONSIDERATIONS

In very brightly lit areas the strong contrast between a light aluminum scraper bar and a dark wiper strip can sometimes create a strobe effect, which should be avoided. To avoid disorientating pedestrians affected by this type of visual disturbance consider using a less contrasting insert.

# The Anatomy.

High quality component and innovative designs combine to create pleasing looks and unparalleled performance.

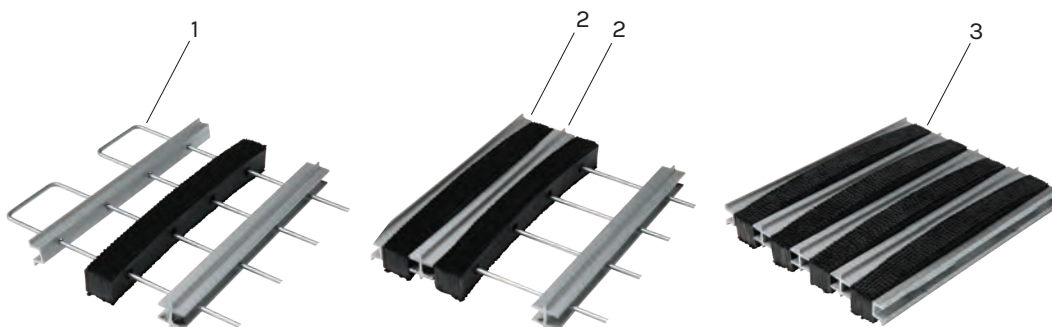

## 1. LINKAGES

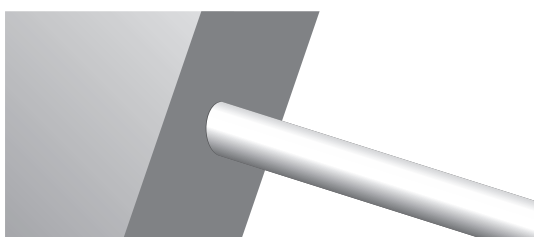

High tensile steel wire.

## 2. SCRAPER BARS & FEATURE STRIPS

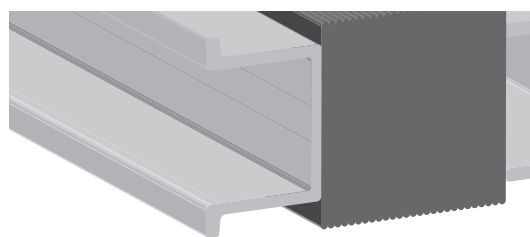

Anodised aluminium and reversible.

## 3. WIPER STRIPS

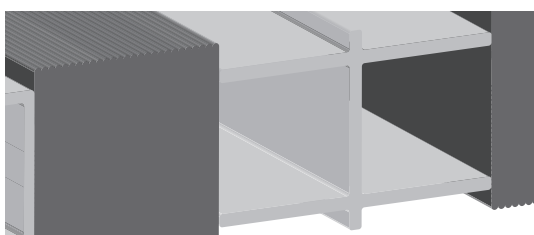

Prime rubber and fibre composite reversible

## 4. OPTIONS

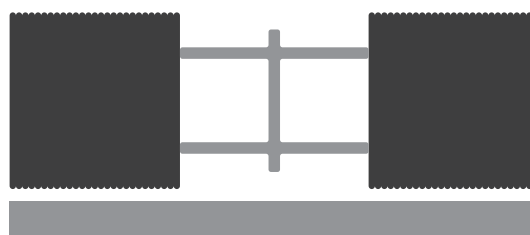

Available in 12mm or 17mm Depth

## Open or Closed Construction

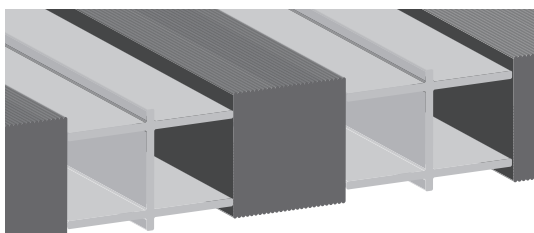

Module 1 Closed

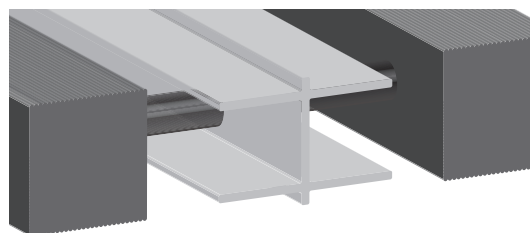

Module 1 semi-open

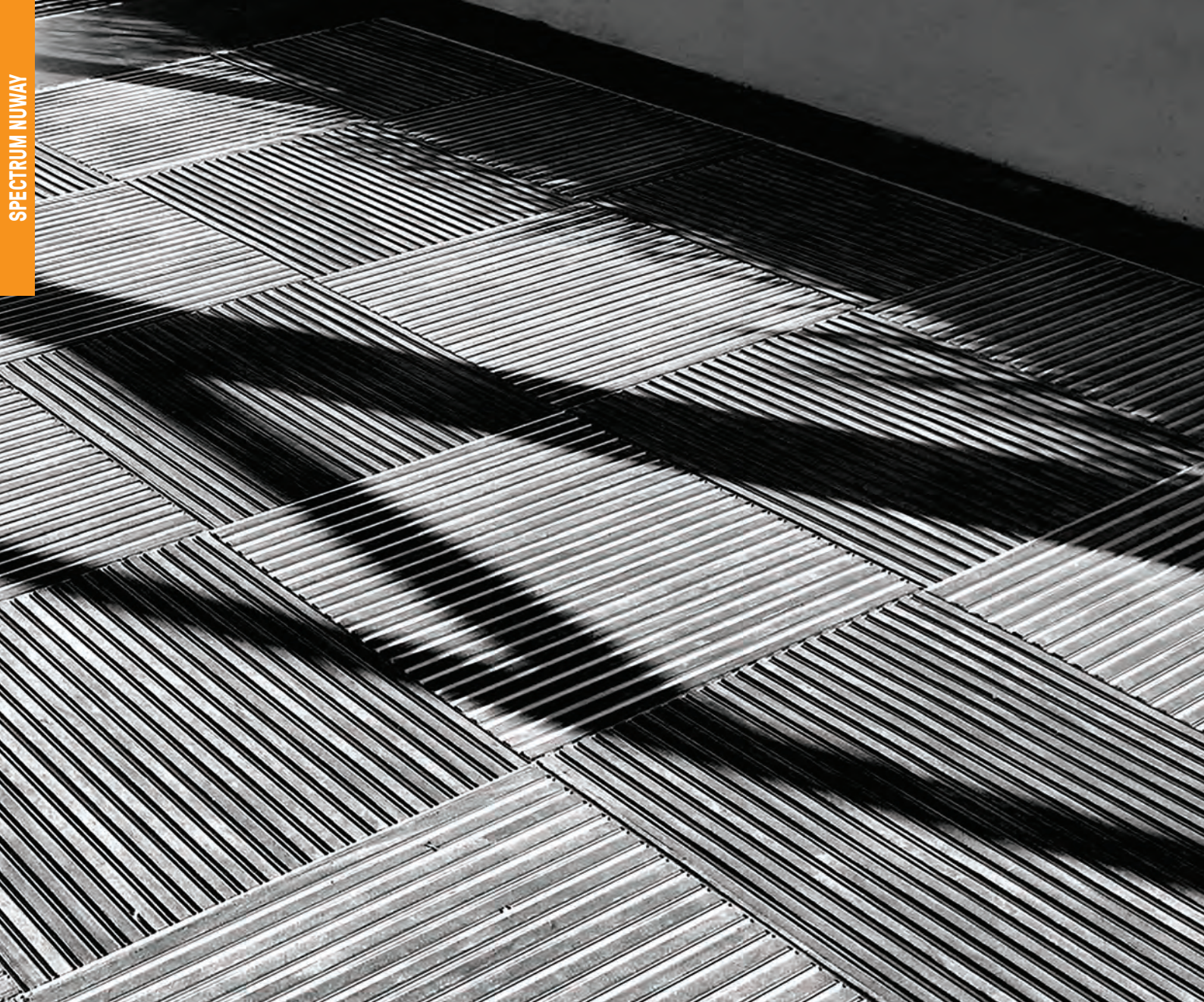

^ Classic

**Intelligent use of modules  
can be used to work with  
multi-directional traffic.**

# SPECIFICATION OPTIONS.

## Carpets / Resilient Finishes

### Entrance matting

**Manufacturer:** Spectrum Nuway Matting Systems, 8 Selgar Ave,  
Tonsley, South Australia 5042, Tel: 1300 786 585, Fax: 1300 786 587

**Product reference:** Spectrum Nuway entrance flooring system Design /  
Classic / or Duraguard (Select option)

Installed in format in accordance with manufacturers instructions.  
Spectrum Nuway entrance flooring system of ..... (and select)  
thickness, scraper bars, module, and type of construction.

(Select from current page)

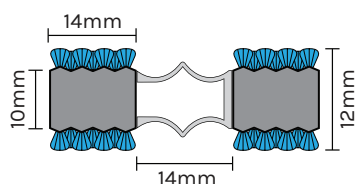

12mm Module 1 closed

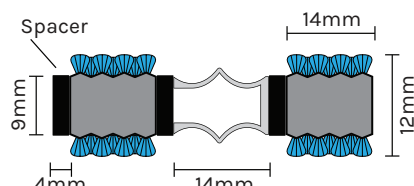

12mm Module 1 semi-open

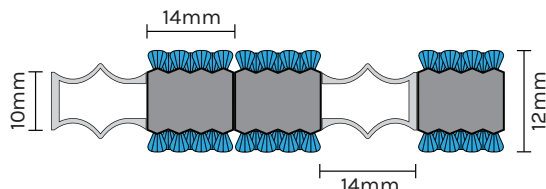

12mm Module 2 closed

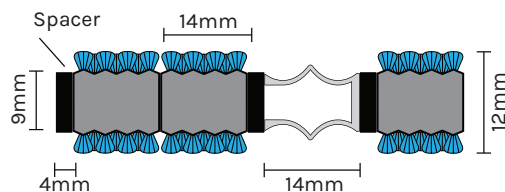

12mm Module 2 semi-open

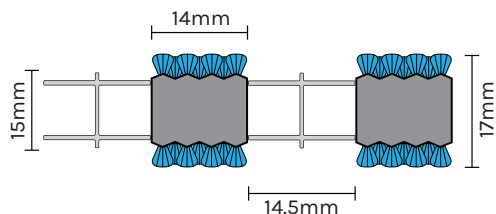

17mm Module 1 closed

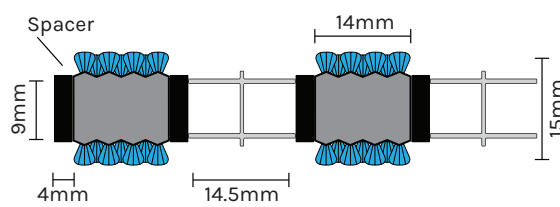

17mm Module 1 semi-open

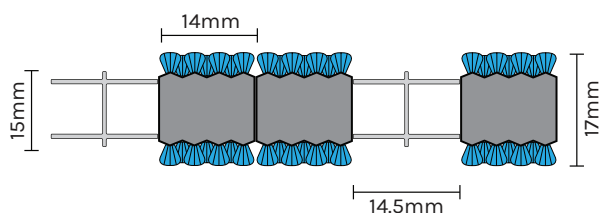

17mm Module 2 closed

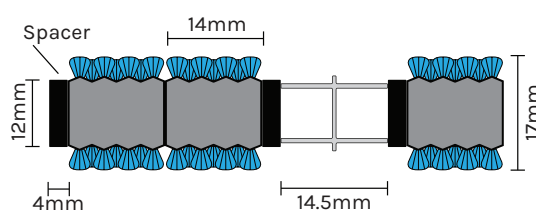

17mm Module 2 semi-open

\*Drawings are diagrammatic and not to exact dimensions or depiction.

# Details and Accessories integral to successful installation.

## Recessed frames/ Installation.

Spectrum matwell frames are available in anodised aluminum, and are designed to anchor into sand and cement screeds for secure site installation. All frames are custom built to fit specific site requirements, with curved shapes available to special order. Spectrum Nuway frames are supplied in kit form for ease of transport, storage and on-site assembly.

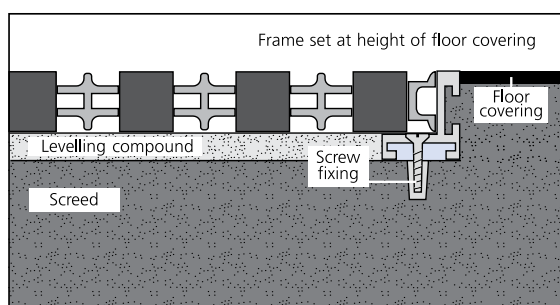

Cross section of matwell frame set into screed with screw fixing

## Cleaning, maintenance and aftercare.

Spectrum Nuway entrance flooring systems effectively stop dirt from entering a building. To maintain optimum performance, and for the warranty it is essential to regularly remove soiling to prevent the product from becoming saturated and lose its ability to perform. Detailed instructions are available on request.

## Nuframe dimensional drawing

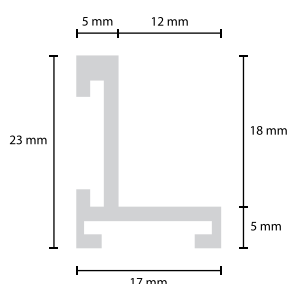

## Ramped frames /Surface mounted installations.

Internal and external ramp frames are supplied mitered. The surface is ribbed for enhanced grip.

### ARF50

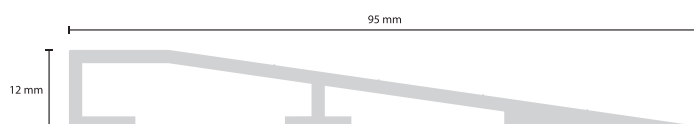

## Nuframe dimensional drawing.

Spectrum Nuway T-Bars can be used to provide a surface mounted matwell frame, mitered and screwed to the existing floor surface where the adjoining floor covering is of sufficient thickness.

Spectrum Nuway T-Bars also provide separation between modules to facilitate easy removal for cleaning, reversibility and as rib alignment is not possible in many installations.

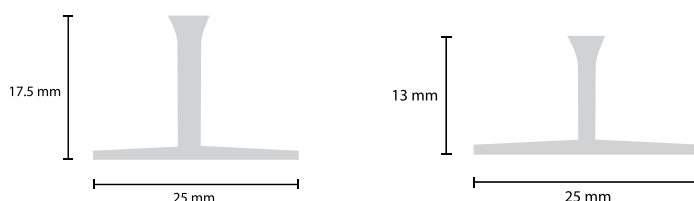

Available in aluminium, T-Bars are automatically included in each order as required.

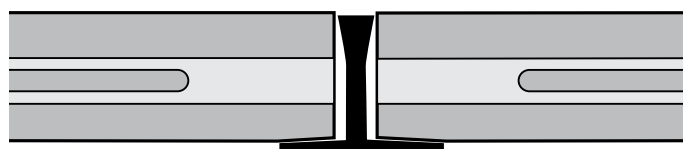

# Improves performance and appearance with interchangeability and reversibility.

## **Infinite shaping options.**

Spectrum Nuway products can be provided in all shapes and configurations. The Spectrum Nuway team can work from a template provided in consultation with our national team.

## **Adding a personality.**

Spectrum Nuway's Design systems can be personalized with copy, logos, crests and messages.

## **Intelligent Modularity.**

To maximize on capital outlay, consideration should be given in the planning stage, to the design of the mat layout. A symmetrical design enables the use of regular size modules, which may be inter-changed to maximize wear without the overall appearance of the mat changing.

For example the outer edge modules can be "swapped" with the center section modules, which may have more traffic passing over them.

## **Configuration planning for multi-directional traffic.**

In large, multi-directional traffic installations optimize the performance with the flexibility of Spectrum Nuway Modular tiles. These can be configured to enable interchangeability

and reversibility, for return on investment and appearance retention.

## **Site Preparation.**

The correct preparation is important to assure the durability and safety of Spectrum Nuway products. Spectrum Nuway Matting Systems are able to provide details of our approved, network of trained distributors.

## **Matwell Subfloors.**

These must be of sound construction, dry, smooth and level. Prior to installation the surface should be clean and free from contamination.

## **Internal applications.**

The screed should be flat and level to accommodate the depth of the chosen mat.

## **External applications.**

Again the screed should be flat and level to the depth of the frame, and thought must be given to drainage.

All Specifications are correct at time of print but are subject to change at the discretion of the supplier.

For more information visit  
[spectrumfloors.com.au](http://spectrumfloors.com.au)

Head Office & Despatch Centre  
8 Selgar Avenue,  
TONSLEY South Australia 5042

Phone: 1300 786 585  
Email: [admin@spectrumfloors.com.au](mailto:admin@spectrumfloors.com.au)  
Web: [www.spectrumfloors.com.au](http://www.spectrumfloors.com.au)



This information is correct at the time of printing 20/08/2018 but the manufacturer reserves the right to carry out modification aimed at product improvement without notice. NOTE: Due to manufacturing limitations there may be variations between the colours of actual flooring and samples images in this brochure. © Spectrum Floors 2018